

FDI France MEDICAL

USER MANUAL

ACCESSORY TRIPOD









IMPORTANT: Before using this product, read this manual and save for future reference.

User: If you are unable to read or understand the warnings, cautions, or instructions contact a healthcare professional or dealer before attempting to use this equipment otherwise injury or damage may occur.

Consult your physician or healthcare specialist before using any type of mobility device used with the TRIPOD. He will advise and inform you about the most appropriate way of walking, climbing stairs, getting up from a chair or sitting down with elbow crutches or a walking stick.

Dealer: This manual must be given to the user of the product.

1. SYMBOLS ON THE LABEL OR IN THE USER MANUAL

	Address of the manufacturer		Invitation to consult the user manual
	Date of manufacture		Respect the safety instruction
	Batch number		CE Conformity
	Product reference		

2. INTENDED USE

TRIPOD is a specific accessory for FDI France MEDICAL elbow crutches and walking sticks. TRIPOD is designed to enable the elbow crutch or the walking stick own on any flat surface when it is not used. Once installed, the TRIPOD can remain attached to the walking aid device. Its compact design and minimal weight ensure that the walking aid device can be used normally with the TRIPOD attached. If required it is possible to block the lower part of the TRIPOD in a high position so that it no longer touches the floor.

3. INSTALL/ UNINSTALL

TRIPOD is easy to install on all models of the FDI France MEDICAL elbow crutches or walking sticks.

3.1 Install

The central opening of the TRIPOD cap is dimensioned to insert 19mm diameter tube walking aid device. TRIPOD is supplied with a base (ferrule).

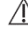
- Remove the base of the walking aid device: hold the tube of the walking aid device firmly in one hand, and remove the base with the other hand by turning it off the walking aid device (1 and 2).
- Place the TRIPOD in low position on the ground (3). Refer section 4.2 "User manual".
- Position the low-end tube of the walking aid device above the central opening cap (3).
- Proceed to the nesting: gradually press the tube until the complete blocking (4).
-  Before using the walking aid device, make sure the tube is properly inserted into the TRIPOD.

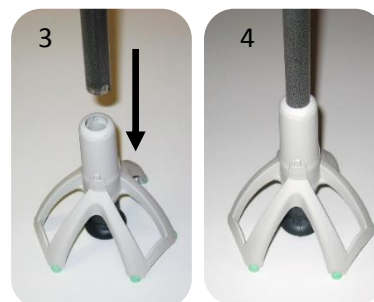
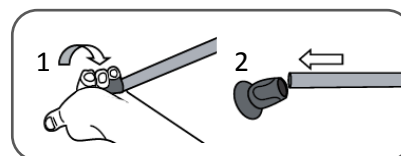

The TRIPOD is now operational: you can walk with the TRIPOD attached to the walking aid device, and leave it standing upright whenever required.

3.2 Uninstall

- Place the TRIPOD in low position, refer section 4.1 “User manual”.
- Remove the TRIPOD of the walking aid device: hold the tube of the walking aid device firmly in one hand, and remove the TRIPOD with the other hand by turning it off the walking aid device.
- Proceed to the re-installation of the base (ferrule) on the walking aid device: push the new base with your hand onto the tube.
- ⚠ Place the walking aid device on the floor and gradually bring your full weight on the walking aid device until it has reached the bottom of the base.
- ⚠ Before using the walking aid device, make sure that the base is correctly inserted.

Your elbow crutch or walking stick is now operational.

Attention: If you operate the TRIPOD without the lower tube inserted in the cap, you may damage the internal mechanism of the TRIPOD.

The TRIPOD should not be removed and re-installed on the crutch repetitively without cause as this may wear out the internal holding mechanism.

4. USER MANUAL

Attention :

This user manual only concerns the use of the TRIPOD. Please refer to the user manual of your elbow crutches or walking stick in order to obtain information on how to use them, the precautions for use, their care and maintenance.

During the walk, TRIPOD must be in high position, the support must be done only on the base.

If any damage is found, DO NOT use the product. In case of missing or damaged part, seek advice from your pharmacist or dealer.

4.1 When walking :

Block the TRIPOD in its high position, the 6 stabilization pads must not touch the ground.

- Grasp the tube of your walking aid device with one hand, and with the other hand the cap (A) du TRIPOD.
- Pull the TRIPOD straight towards the top of the walking aid device until it reaches a stop (5).
- Make a slight rotation of the cap (A).
- Release the TRIPOD, it will remain in its high position.

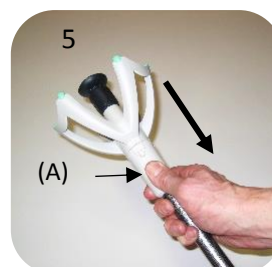

4.2 Keeping the walking aid device upright:

Block the TRIPOD in its low position, the 6 stabilization pads touch the ground.

- Grasp the tube of your walking aid device with one hand, and with the other hand the cap (A) du TRIPOD.
- Practice a slight rotation (6).
- The TRIPOD is repositioning itself automatically.
- You can also reposition the TRIPOD by a rotational movement with your foot (7).

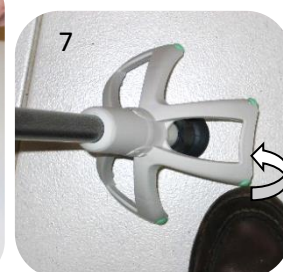
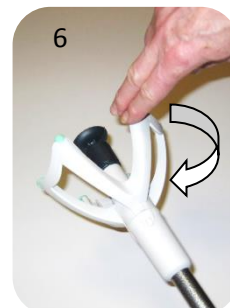

5. PRECAUTIONS OF USE

⚠ Failure to comply with the precautions of use may result a serious injury.

- **When walking, the TRIPOD must be in a high position, the support must be done only on the base.**

- Regarding precautions of use when using elbow crutch or walking stick, you must refer to their instruction manual.

6. CARE AND MAINTENANCE

⚠ The lack of care and maintenance of your TRIPOD and walking aid device (elbow crutches, walking stick) may cause injury, you must refer to their respective instruction manual.

- Regular cleaning of TRIPOD is recommended. TRIPOD and base (ferrule) must be cleaned with clear water. Wipe all surfaces with a damp soft cloth and allow all surfaces to dry before use. Do not use any abrasive product, cleaning product, chemical product, greasy product that could make them slippery or any product that contain bleach.
- As elbow crutches and walking sticks, TRIPOD must be very regularly controlled; for your security we recommend a control every 6 month by a healthcare professional. Regular inspection of parts including hardware, brackets and plastics for deformation, corrosion, breakage, wear or compression.
- Control the worn state or the cracking on the 3 feet of the TRIPOD, the 6 stabilization pads and the base. Depending on the surface on which the walking aid devices are used, the bases will wear out more or less quickly.
- In order to ensure a safety and continuous use, worn parts (base, stabilization pads) or cracking parts must be replaced immediately. Exclusively use manufacturer spare parts. You could get the spare parts from your pharmacist or dealer.
- Must not modify this product other than by replacing worn parts.
- In case of non-use for an extended period, we recommend a new control by a healthcare professional before any new use.

Your specialist is the only one authorized to perform maintenance on your TRIPOD.

7. REPLACEMENT OF USED PARTS

7.1 Replacement of base (ferrule)



- Block the TRIPOD in its high position.
- Hold the TRIPOD firmly with one hand and remove the base with the other hand by turning it off the walking aid device.
- Push the new base onto the walking aid device.
- ⚠ Place the walking aid device on the floor and gradually bring your full weight on it until the walking aid device has reached the bottom of the base.
- ⚠ Before using the walking aid device, make sure that the base in the TRIPOD is correctly inserted.

7.2 Replacement of stabilization pads

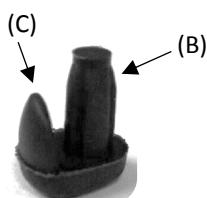

- Remove the worn stabilization pad.
- Insert the stabilization pad (B), making sure to place the heel (C) on the outer face of the TRIPOD.
- ⚠ Before using the walking aid device with the TRIPOD, make sure that the stabilization pad is correctly inserted.

8. STORAGE

⚠ Failure to comply with storage conditions may result in damage of the TRIPOD.

- Do not store the product in directly exposed to a source of extreme heat (for example behind a window or near a radiator) or cold places.
- If exposed to extreme temperature, above 41°C, the TRIPOD will be hot and first-degree burns may occur. Allow the TRIPOD to cool before using.
- Keep away from any source of ignition and flame.
- Follow the storage conditions of the TRIPOD as below:
 - Keep it in a dry place between 5°C and 41°C.
 - The relative humidity of the air should be between 30% and 70%.
 - Protect your TRIPOD against the dust, corrosion (abrasive elements, sand, sea water, salt air) or greasy environment by packaging them.

9. DISPOSAL

Our TRIPOD is made of plastic and metal parts: these materials are inert, non-toxic and non-biodegradable. For its disposal, this product is considered as domestic waste, and your local regulations in this regard have to be respected. Please be environmentally responsible and recycle this product through your recycling facility at its end of life.

10. TECHNICAL SPECIFICATIONS

Make sure that the label on the TRIPOD stays always legible. Replace it if necessary after a demand to your dealer.



MODEL	TRIPOD
Weight	110 g
Height	160 mm
Central opening	19 mm
Width of the base	150 mm
SPARE PARTS	
Stabilization pads	
Base/ Ferrule	



FDI France Médical

77 Route de Buatière, Fitilieu
 38490 Les Abrets en Dauphiné- France
 Tel : +33 (0)4 76 32 27 33
www.fdifrance.com



The TRIPOD, accessory of the elbow crutch and walking stick is a Class I Medical Devices according to the European Union Directive 93/42/EEC.